

Office/Dental/Medical Office

OFFICE FOR LEASE

4310 Colby Avenue
Everett WA 98203

THE OPPORTUNITY

Well maintained Medical/Dental three-story office building with elevator and ample surface parking. Highly visible corner with prominent signage on Colby Avenue with close proximity to Interstate-5 and Evergreen Way. Different configurations available including some rare small space opportunities.



HIGHLIGHTS

Average Household Income
3 Mile - \$76,990
5 Mile - \$79,973

Easy Access from I-5 and Evergreen Way

Highly Visible Location with over 162,000
vehicles per day at I-5 & 41st Street (.41 miles from site)

Located in Rapid Growing Area



Christian Decker (206) 283-5212
www.wccommercialrealty.com

DISCLAIMER: The above information has been secured from sources believed to be reliable, however, no representations are made to its accuracy. Prospective tenants or buyers should consult their professional advisors and conduct their own independent investigation. Site plan and configuration are subject to change. Properties are subject to change in price and/or availability without notice. West Coast Commercial Realty, LLC

WCCR

West Coast Commercial Realty

Retail
Commercial
Specialists

Office/Dental/Medical Office

OFFICE FOR LEASE

4310 Colby Avenue
Everett WA 98203



Christian Decker

(206) 283-5212

www.wccommercialrealty.com

DISCLAIMER: The above information has been secured from sources believed to be reliable, however, no representations are made to its accuracy. Prospective tenants or buyers should consult their professional advisors and conduct their own independent investigation. Site plan and configuration are subject to change. Properties are subject to change in price and/or availability without notice. West Coast Commercial Realty, LLC

WCCR

West Coast Commercial Realty

Retail
Commercial
Specialists

Office/Dental/Medical Office

OFFICE FOR LEASE

4310 Colby Avenue
Everett WA 98203



DISCLAIMER: The above information has been secured from sources believed to be reliable, however, no representations are made to its accuracy. Prospective tenants or buyers should consult their professional advisors and conduct their own independent investigation. Site plan and configuration are subject to change. Properties are subject to change in price and/or availability without notice. West Coast Commercial Realty, LLC

Christian Decker (206) 283-5212
www.wccommercialrealty.com

WCCR

West Coast Commercial Realty

Retail
Commercial
Specialists

Office/Dental/Medical Office

OFFICE FOR LEASE

4310 Colby Avenue
Everett WA 98203

FLOOR PLAN : First Floor

Suite 101 -
1,183 RSF
(Do Not Disturb Tenant)



Colby Avenue
Parking Lot



Christian Decker (206) 283-5212
www.wccommercialrealty.com

DISCLAIMER: The above information has been secured from sources believed to be reliable, however, no representations are made to its accuracy. Prospective tenants or buyers should consult their professional advisors and conduct their own independent investigation. Site plan and configuration are subject to change. Properties are subject to change in price and/or availability without notice. West Coast Commercial Realty, LLC

WCCR

West Coast Commercial Realty

Retail
Commercial
Specialists

Office/Dental/Medical Office

OFFICE FOR LEASE

4310 Colby Avenue
Everett WA 98203

FLOOR PLAN : Second Floor

Suite 201 -
1,484 RSF
(Do Not Disturb Tenant)

Suite 202 -
1,132 RSF
(Do Not Disturb Tenant)

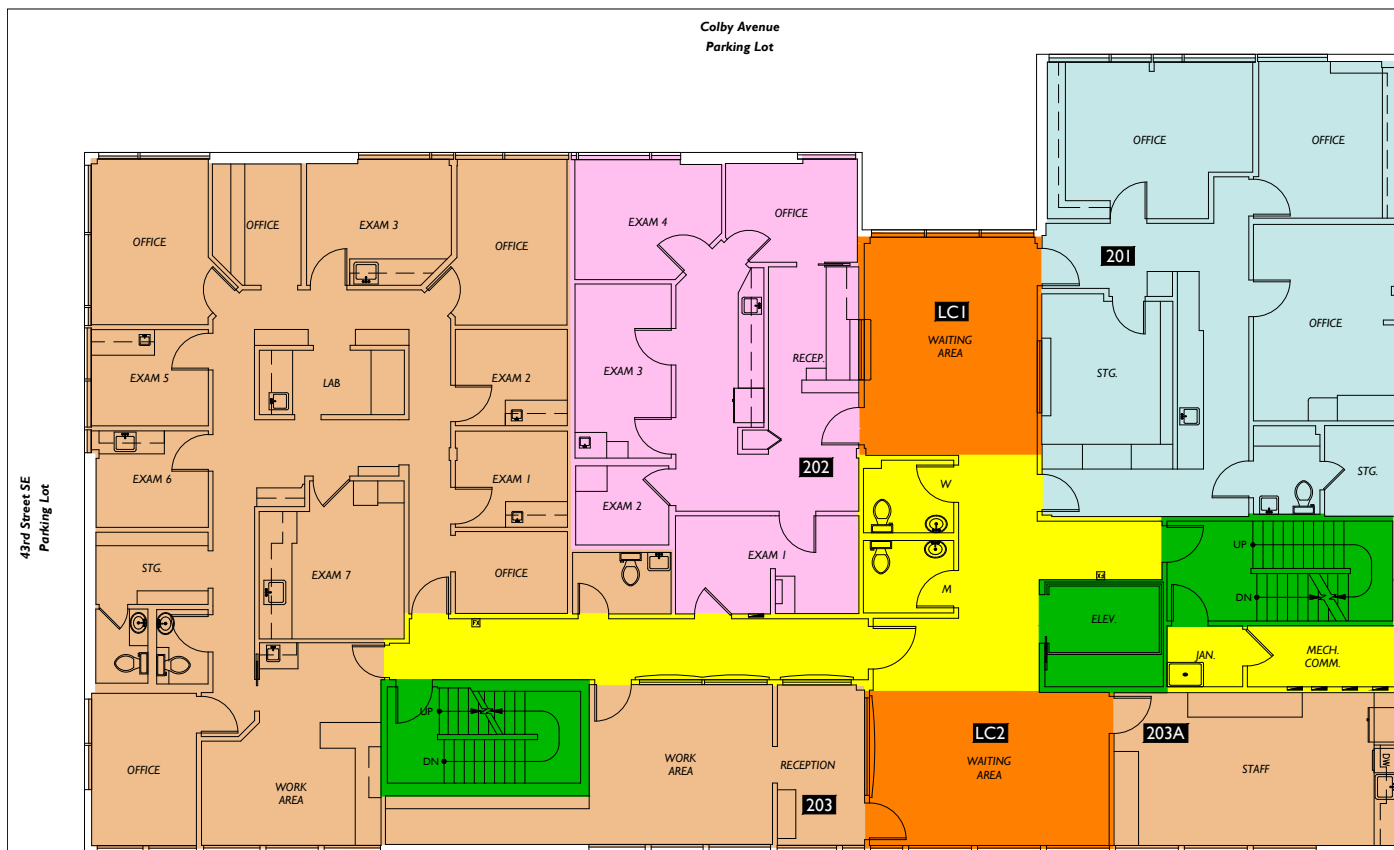

Christian Decker (206) 283-5212
www.wccommercialrealty.com

DISCLAIMER: The above information has been secured from sources believed to be reliable, however, no representations are made to its accuracy. Prospective tenants or buyers should consult their professional advisors and conduct their own independent investigation. Site plan and configuration are subject to change. Properties are subject to change in price and/or availability without notice. West Coast Commercial Realty, LLC

WCCR

West Coast Commercial Realty

Retail
Commercial
Specialists

Office/Dental/Medical Office

OFFICE FOR LEASE

4310 Colby Avenue
Everett WA 98203

FLOOR PLAN : Third Floor

Suite 300-

5,113 RSF

(Do Not Disturb Tenant)

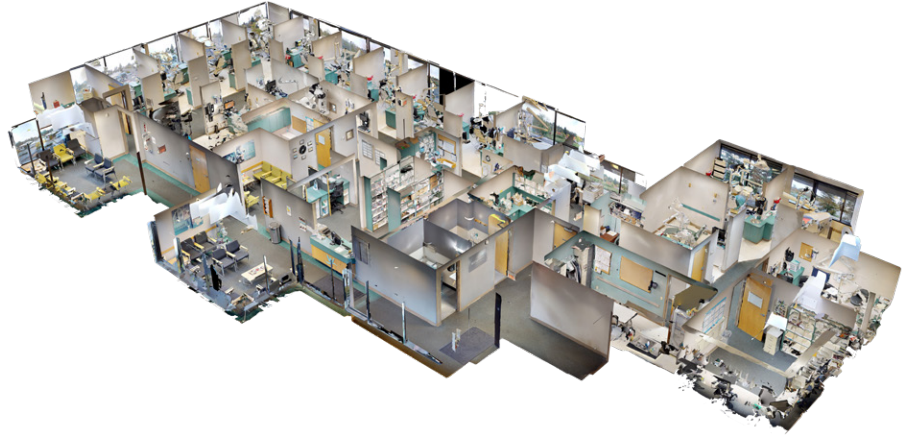

Colby Avenue
Parking Lot



Christian Decker (206) 283-5212
www.wccommercialrealty.com

DISCLAIMER: The above information has been secured from sources believed to be reliable, however, no representations are made to its accuracy. Prospective tenants or buyers should consult their professional advisors and conduct their own independent investigation. Site plan and configuration are subject to change. Properties are subject to change in price and/or availability without notice. West Coast Commercial Realty, LLC

WCCR

West Coast Commercial Realty

Retail
Commercial
Specialists