

Shoreline Park Office Building

19940 Ballinger Way NE ♦ Shoreline WA 98155



Fully Leased

1,090 SF



LOCATION FEATURES

- Located in the Retail Core of Ballinger Way
- Close Proximity to Interstate-5 and Highway 99
- High Traffic Site with Over 20,000 Vehicles Per Day Traveling Ballinger Way
- Large On-site Parking Lot
- Large open layout with two private offices
- Available November 2015

DEMOGRAPHICS

Population		Average HH Income	
1 Mile:	14,854	1 Mile:	\$79,548
2 Mile:	59,249	2 Mile:	\$80,564
3 Mile:	129,399	3 Mile:	\$82,934

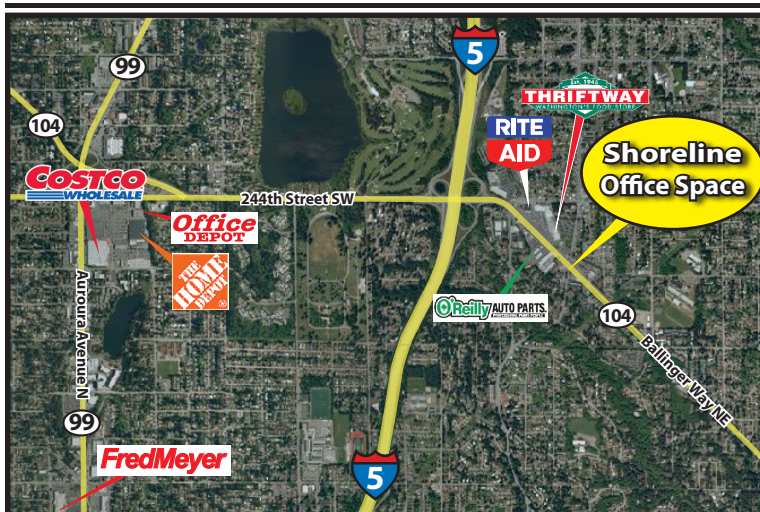

**WestCoast
Commercial**

For more information call:
(206) 283-5212

R E A L T Y

Retail Commercial Specialists



Blake Taylor

2101 Fourth Avenue, Suite 920 - Seattle, WA 98121

www.wccommercialrealty.com

DISCLAIMER: The above information has been secured from sources believed to be reliable, however, no representations are made to its accuracy. Prospective tenants or buyers should consult their professional advisors and conduct their own independent investigation. Site plan and configuration are subject to change. Properties are subject to change in price and/or availability without notice. West Coast Commercial Realty, LLC

CoStar
POWERBROKER
2014 Top Firm Award

CBA **COMMERCIAL BROKERS**
ASSOCIATION

ICSC
International Council of Shopping Centers

Shoreline Park Office Building

19940 Ballinger Way NE ♦ Shoreline, WA 98155

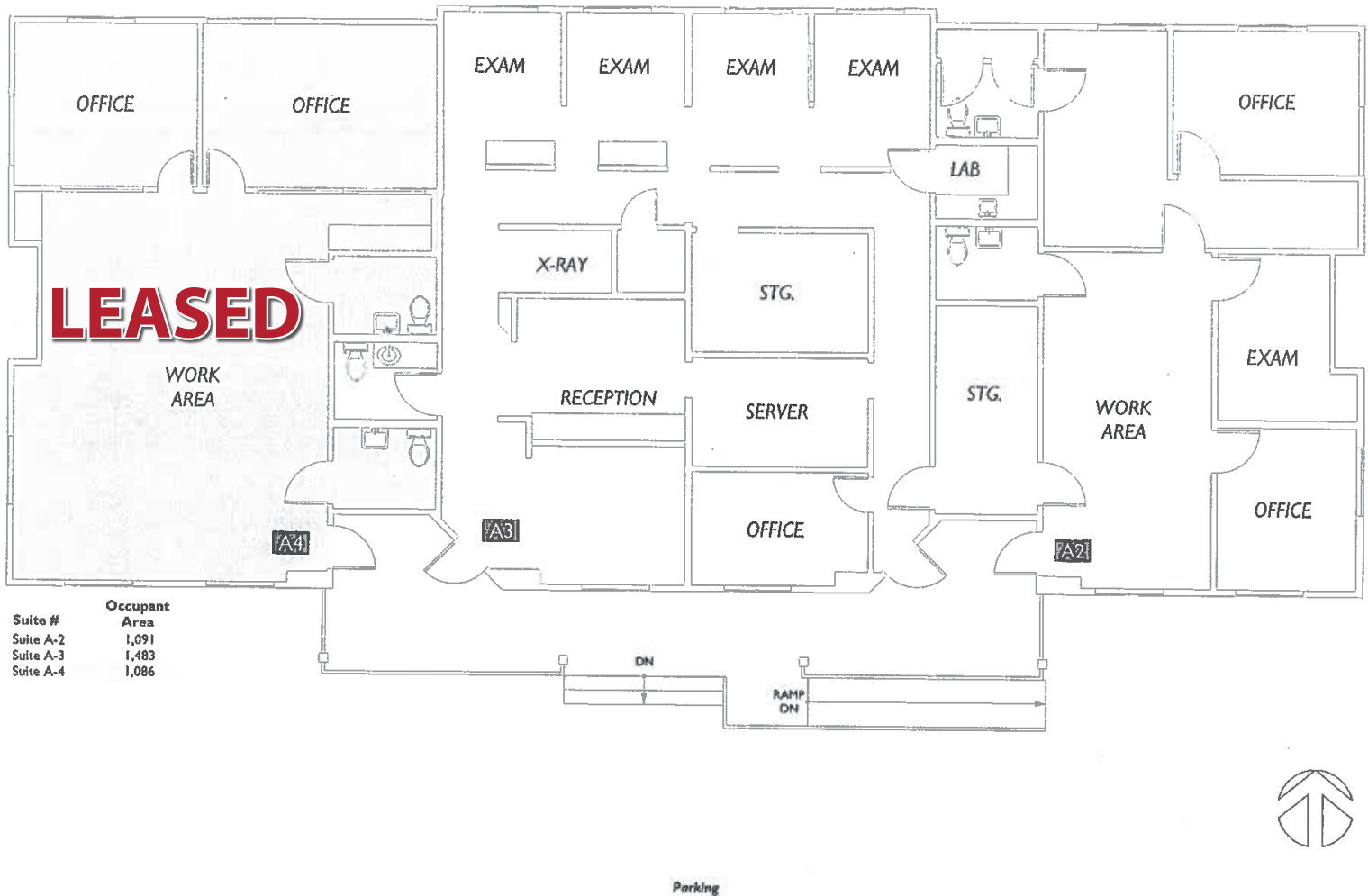

WestCoast
Commercial

R E A L T Y

For more information call:
(206) 283-5212

Retail Commercial Specialists



Blake Taylor

2101 Fourth Avenue, Suite 920 - Seattle, WA 98121

www.wccommercialrealty.com

DISCLAIMER: The above information has been secured from sources believed to be reliable, however, no representations are made to its accuracy. Prospective tenants or buyers should consult their professional advisors and conduct their own independent investigation. Site plan and configuration are subject to change. Properties are subject to change in price and/or availability without notice. West Coast Commercial Realty, LLC



POWERBROKER



COMMERCIAL BROKERS ASSOCIATION

2014 Top Firm Award



International Council of Shopping Centers